

We are transitioning our **Check – In/Out** procedure to a new contactless option from Procare. They still have it under development and not all the features are available from the app, but you will be able to use the Check option.

First step: Download the app from the AppStore from Apple or Google (Depending if you have an [iPhone/iPad](#) or [Android](#) device) in your device.

App Store Preview

Open the Mac App Store to buy and download apps.



Procare: Childcare App 4+

Daily Sheet, Sign-In & Billing
Kinderlime Inc

#172 in Education

★★★★★ 4.9 • 12.4K Ratings

Free

You should have received an email with the subject

[Action Required] New Generation Montessori has invited you to join Procare

This email has the download links and instructions to complete your sign up and a unique code for your family.

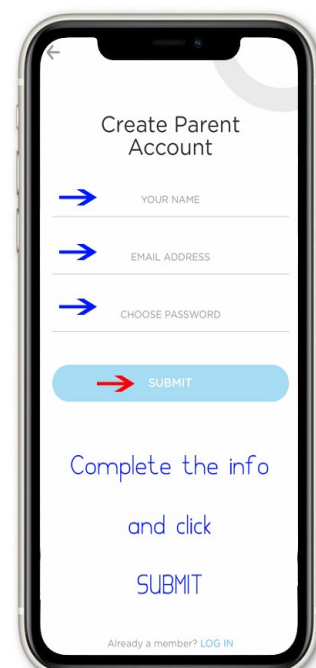
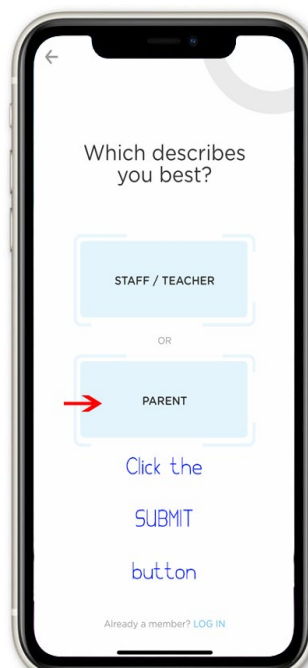
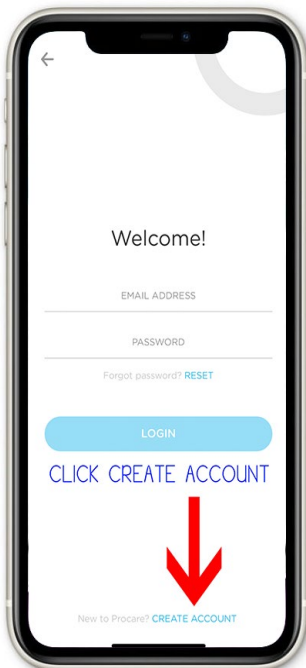

Once you entered the information you may be required to register a child:

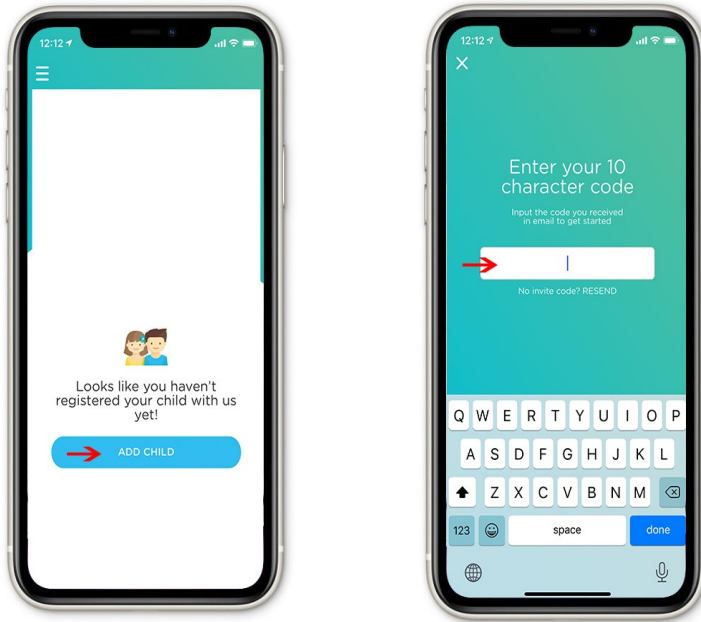

Enter the code received on the invitation email (Note this code expires after a week)

Then you are ready to use the app.

Log In Process:

When you open the app for the first time will show a screen like the image below. Please note that there is a **very small link** below the sign up button with the LOG IN link. **Do not** click SIGN UP. Click only the link "LOG IN". Then enter your email and chosen password.

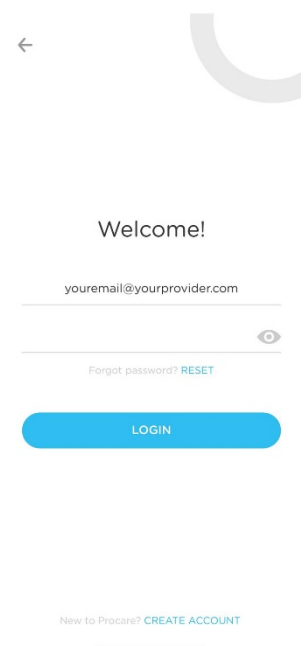
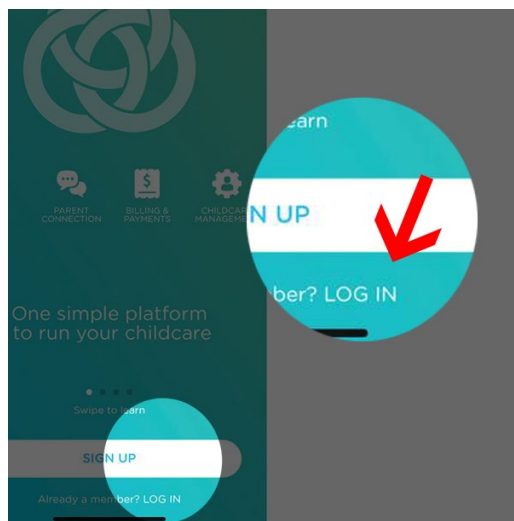
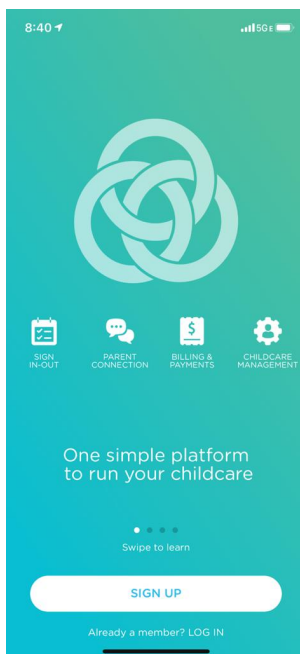

Check In/out process

To Check in/out your child, when you are at the school, you'll need to launch your app and click on a very little icon on the top of the app:

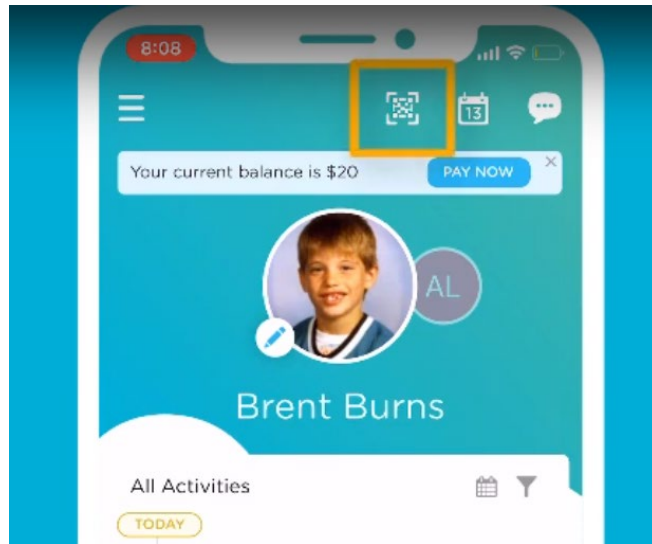

Your phone may send you an alert to **authorize the app** to use your camera, Please accept that, and will activate the camera looking for a QR code, but look at the bottom of the phone, there is a message that says "Looks like you are in school.."

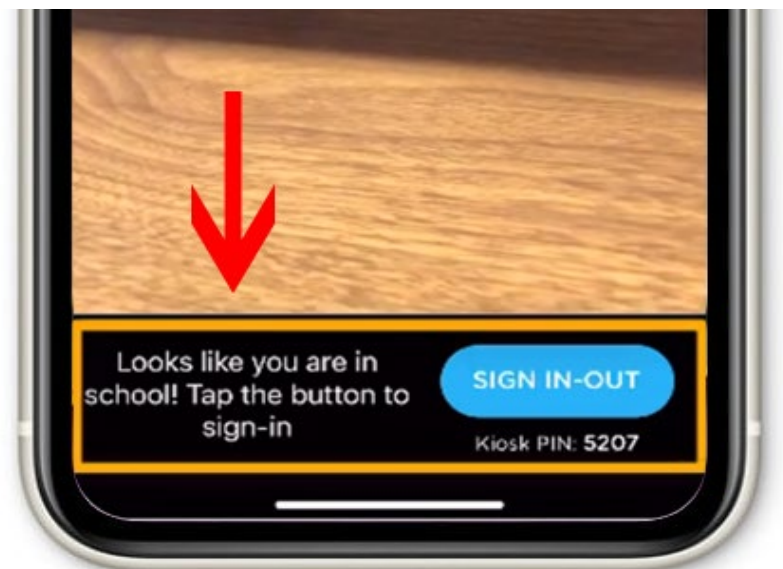
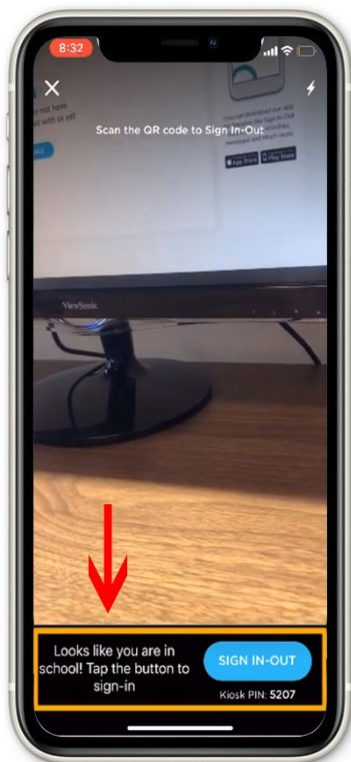

Then you child(s) is displayed. A blue button in the bottom will say SIGN-IN (or OUT). Please click there.

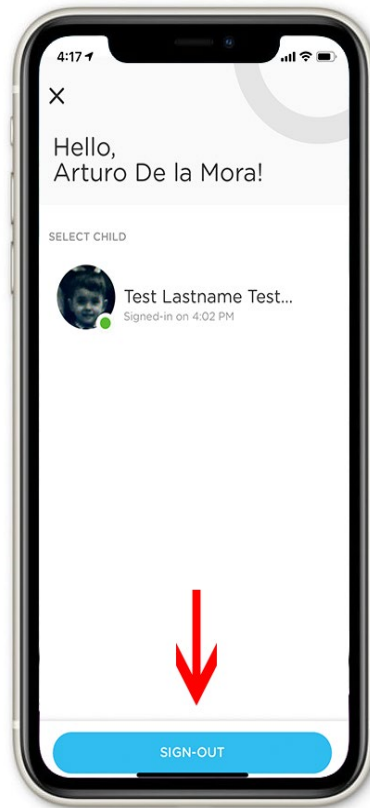

A white screen will appear. This is where you must sign with your finger. **If you don't sign, the app won't complete the process.** Once you sign with your finger, click the button that says DONE



If you have another child, select him/her from the list and complete the process.

That's it!

If you have any question, please email us to app@ngmca.com and we will get back to you!

Thank you for helping us to make our school a safer place for all!

Respectfully,

New Generation Montessori.